

# PENDARSWITCH SERIES

## • DESCRIPTION

Switches and indicators described here can be used as part of a gang switch assembly, with mounting adaptors or individual mounting. They are designed for electronic equipment where long life, reliable operation and good appearance are required. They can be equipped with any of the single and multi-lamp lenses.

The PENDARSWITCH range is a response to the needs of the control industries market and is designed to meet military specifications and aerospace requirements.



## • CONTACTS

### 1. Dual wiping contacts (SA and SB series)

Wiping contacts are designed for low current switching. They are self-cleaning.

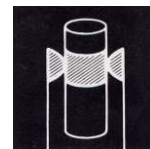

Dual wiping action

### 2. Snap-action contacts (SC series)

Switches with these contacts are used in electrical and electronic equipment where higher current switching is required.

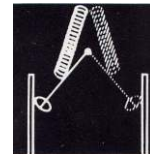

Snap action

## • ACTIONS

### 1. Momentary

Depressing lens of switch will close normally-open contacts and open normally-closed contacts. When no longer depressed, contacts and lens come back to their original position.

### 2. Alternate

Depressing lens of switch will close normally-open contacts and open normally-closed contacts. When pressure is removed, contacts remain in their depressed position but the lens returns to its original position. To restore the contacts to their original position, the lens must be depressed again.

### 3. Alternate, Remain-in

See "Alternate-Action", but lens remains in depressed position. To restore contacts and lens, the lens must be depressed once again.

## • ENVIRONMENTAL CHARACTERISTICS

**1. Vibration** : Measurements following MIL-STD-202, method 204 or 10 g double amplitude. Frequency range is 10 to 50 Hz.

**2. Mechanical shock** : Measurements following MIL-STD-202, method 213; 50g. 10 msec, half sine.

**3. Thermal Shock** : Measurements following MIL-STD-202, method 107, test conditions A.

**4. Salt spray** : Switches with moisture protection (option). Measurements following MIL-STD-202, method 101.

**5. Moisture Resistance** : Switches with moisture protection. Measurements following MIL-STD-202, method 106.

# PENDARSWITCHES

## • DIMENSIONS

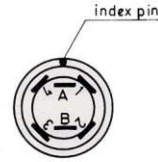
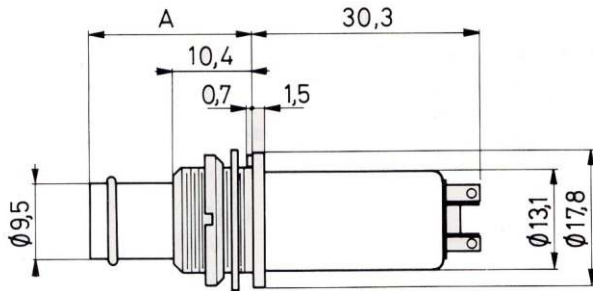

**SA**

1NO and  
1NC contact

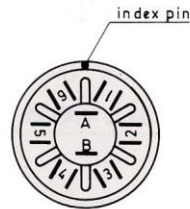
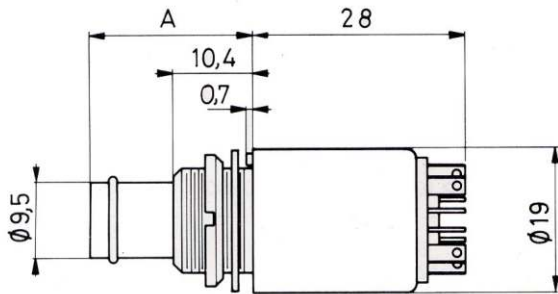

**SB**

6 contacts  
(NO/NC  
combinations)

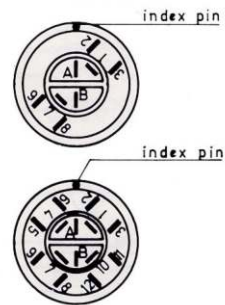
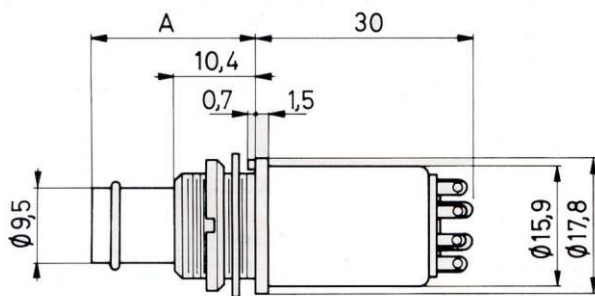

**SC**

2 or 4  
change-over  
contacts

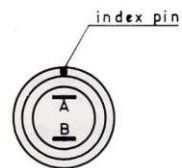
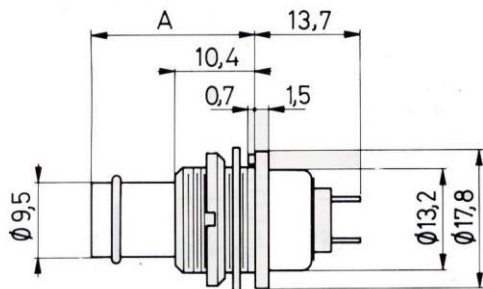

**SM**

Lamp  
indicator

## • PANEL CUT-OUT

Min. panel thickness :  
1 mm (.040")  
Max. panel thickness :  
6 mm (.0220")

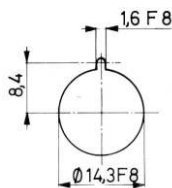

	Dim. A	Plunger length
1	21.3 mm (.84")	- for loose switches and adaptor mounting
2	24.5 mm (.96")	- for Series I and II frames
3	29.2 mm (1.15")	- for Series III and IV frames



NSI bvba, Haakstraat 1A, B-3740 Bilzen, Belgium  
Tel. : ++32 (0) 89 51 90 00 Website : [www.nsi-be.com](http://www.nsi-be.com)  
Fax : ++32 (0) 89 51 90 09 E-mail : [info@nsi-be.com](mailto:info@nsi-be.com)